

WANG

2200
INSTALLATION
GUIDE

SYSTEM 2200

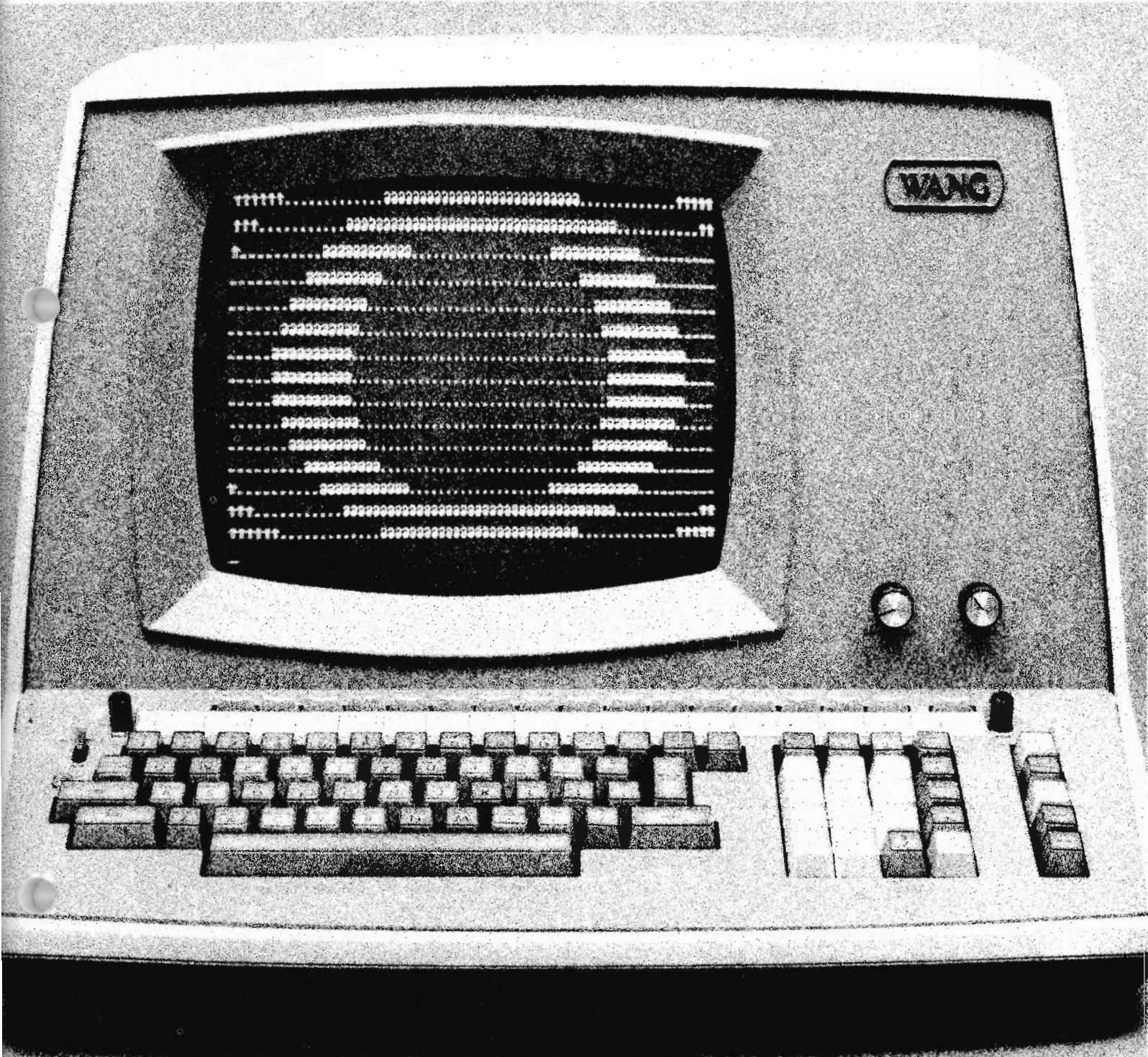



2200 Installation Guide

© Wang Laboratories, Inc., 1976



LABORATORIES, INC.

836 NORTH STREET, TEWKSBURY, MASSACHUSETTS 01876, TEL. (617) 851-4111. TWX 710 343-6769, TELEX 94-7421

Disclaimer of Warranties and Limitation of Liabilities

The staff of Wang Laboratories, Inc., has taken due care in preparing this manual; however, nothing contained herein modifies or alters in any way the standard terms and conditions of the Wang purchase agreement, lease agreement, or rental agreement by which this equipment was acquired, nor increases in any way Wang's liability to the customer. In no event shall Wang Laboratories, Inc., or its subsidiaries be liable for incidental or consequential damages in connection with or arising from the use of this manual or any programs contained herein.



LABORATORIES, INC.

836 NORTH STREET, TEWKSBURY, MASSACHUSETTS 01876. TEL (617) 851-4111, TWX 710 343-6769, TELEX 94-7421

Table of Contents

	PAGE
Introduction.	1
Environmental Requirements.	1
Electrical Requirements	2
Site Selection.	3
Site Layout	3
Available Units	11
Central Processors.	11
WCS/10.	12
WCS/20.	13
WCS/30.	14
Model 2201.	15
Model 2202.	16
Model 2203.	17
Model 2209.	18
Model 2212.	19
Models 2216/17.	20
Model 2217.	21
Model 2218.	22
Model 2220.	23
Model 2221W	24
Model 2223.	25
Model 2226.	26
Models 2230, 2260	27
Model 2231.	28
Model 2232A	29
Models 2234A/44A.	30
Model 2261.	31
Model 2262.	32
Model 2270.	33
Model 2290.	34
Model 2291.	35
Model 2292.	36



INTRODUCTION

This manual has been prepared to give you information concerning the physical installation of the units in your system.

The preparation of this document does not assume responsibility for site preparation and installation by Wang Laboratories, Inc. but is designed to assist you in preparing your computer room for efficient operation. It is expected that your Wang Service Representative will perform actual installation of the components of your system.

ENVIRONMENTAL REQUIREMENTS

Temperature, humidity and dust are the three important environmental factors which must be controlled for proper functioning of your system. In general, if the room in which the computer is to be installed is comfortable for the computer operator, it will be satisfactory for the machine itself. Allowable ranges for operating temperature and relative humidity are:

Temperature: 50° to 90°F (10° to 32°C)
Allowable Relative Humidity: 20 to 80%, non-condensing
Recommended Relative Humidity: 35 to 65%, non-condensing

Airborne dust must be controlled so that over a given 24 hour period, no accumulation on the units is obvious.

Temperature can be controlled by the usual heating and air conditioning units. Dust can be effectively controlled by the usual heating, ventilating and cooling equipment if units are supplied with adequate filters. Filters should be cleaned or replaced regularly. If the usual filters do not control dust effectively, an electrostatic filter should be installed.

Humidity outside the recommended range should be controlled by the installation of humidifiers or dehumidifiers. Excessive temperature can cause equipment failure; low humidity can create static discharge which will cause system malfunctions and data loss; dirt can cause mechanical wear in all recording units and can create system malfunctions.

The computer room may be tiled and sound-proofed as desired; in general, it should never be carpeted since carpeting and low humidity can generate significant amounts of static electricity which will cause machine malfunctions. Some office carpeting manufacturers can provide special metal-impregnated anti-static carpeting which can be grounded; this is the only type of carpeting that can be used in the machine room. Spraying existing carpeting with an anti-static agent is not usually sufficient to control static electricity at all times. This problem is particularly severe during winter months when buildings are heated, since heating dries the air and reduces humidity significantly.

ELECTRICAL REQUIREMENTS

The units of your Wang system must be plugged into a dedicated power line (i.e., the line should not be shared with other office equipment such as air conditioners, calculators, water coolers, typewriters, etc.)

Power requirements are:

115 VAC or 230 VAC \pm 10%
50 or 60 Hz \pm 1 Hz
depending on the system purchased.

If the dedicated line (or lines) is not regulated within these limits, a constant voltage transformer must be installed.

Your system, its peripheral units, and the medium on which your data are recorded, are extremely sensitive to electromagnetic interference (EMI). Such electromagnetic noise can be generated by conduction along wiring, or by direct radiation. Any device such as an office machine, an electrical motor, electrical machinery, an arc welder, etc., can generate considerable electrical noise. Any device which generates EMI should be relocated, repaired or filtered. If the noise is in the power line itself, an EMI filter with a cut-off frequency near 10kHz should be installed on the power line, and the power line should be properly installed in steel conduit connected to junction boxes. In extreme cases, it may be necessary to shield the peripheral cables of your system. Any medium, such as disks, cassettes or nine-track tapes must be stored away from sources of electrical interference (it is possible to degauss sections of magnetic tape by operating a vacuum cleaner near data tapes).

Each unit has specific current requirements as indicated in the layout section of this guide. To ensure operator safety, the power lines for all units should be attached only to an appropriately grounded line with the 3-prong plugs provided. It is essential that a system ground be a true ground. If a three-hole outlet is not available, an adapter can be used but it must be appropriately grounded. Normally, a 20 ampere 115 VAC power line is adequate for most Wang systems. However, to determine if a larger line is necessary, find the units of your configuration in the layout section of this guide and add up their amperages. Whenever the sum exceeds 20 amps, a larger line or more than one separate line must be used. For example, a System 2200S with a Model 2220 Console and a Model 2231 printer has the following requirements:

Model	Amps (115V)	(230V)
2200S CPU	2.0A	1.0A
2220	0.6	0.3A
2231	2.6	1.3A
	<u>5.2A</u>	<u>2.6A</u>

Thus, any standard 20 amp line is sufficient to run such a system.

However, the following configuration requires one 40 amp or two 20 amp lines:

Model	Amps (115V)	(230V)
WCS/30	7.8	3.9
2221W	2.6	1.3
2230	7.0	3.5
2234A	13.0	6.5
	<u>30.4A</u>	<u>15.2A</u>

SITE SELECTION

The site you choose for your system will depend on two primary considerations:

- . the task to be done
- . the availability of adequate space.

If the task for which the system is to be used will be the responsibility of, say, the accounting department, then probably the best location for the system will be in or near that department. If it is to be used primarily for shipping documents, then it will best be located near the shipping area, etc.

The site chosen should normally provide room for storage of computer materials such as fan-fold printer paper, disks and diskettes as needed. It may also be a good idea to store at least one copy of every manual for the machine in the same room as the computer for easy access.

SITE LAYOUT

In this guide you will find two Site Grids. One has been ruled in 1 ft squares, the other in 1m squares. The appropriate grid can be used to lay out the walls, doors and windows of the room in which you intend to place your system. It is also a good plan to indicate the location of every wall outlet which can be used. Line drawings of each piece of equipment are also provided; these can be copied and placed on the Site Grid as an aid in planning your site. The line drawings have been drawn to scale and can be used with either Site Grid. Be sure to select the Site Grid ruled in the correct system (English or metric) for your area so that you will accurately lay out your site.

Make a copy of the Site Grid itself to prepare cutouts for additional pieces of office equipment such as bookcases or filing cabinets if you intend to have them in the machine room.

Once you have outlined your room on the Site Grid and indicated all openings, obstructions and wall outlets, you can place the line drawings of equipment on it to plan your layout. Estimate the distance of your equipment from the available wall plugs, since if equipment cables are too short, extension cables must be obtained. In general, the main console can be positioned along a wall in which wall plugs are located. Note that cable lengths are important since not all units can be used with extension cables

and available cables can be obtained only in specific lengths (see individual model specifications).

To illustrate site layout, two typical installations are shown; one contains a large WCS/30 system with an optional Nine-Track Tape Drive (Model 2209), the other contains a small configuration with the small analog plotter (Model 2212).

Manuals provided with your system require a standard bookcase shelf about 2 to 3 ft (0.6 to 1m) long. Diskettes on which programs and data are recorded can be filed in hanging file folders (e.g., Pendaflex files) or in regular upright files. Fixed/removable disk packs can be stored horizontally on shelves, stacked no more than two deep, or in specially constructed shelving, if many are to be stored and readily accessible. Disks may be stored in a remote area if storage space is a problem, but the area must have the same temperature, humidity and dust controls as are maintained in the computer room.

Site Grid (English System)

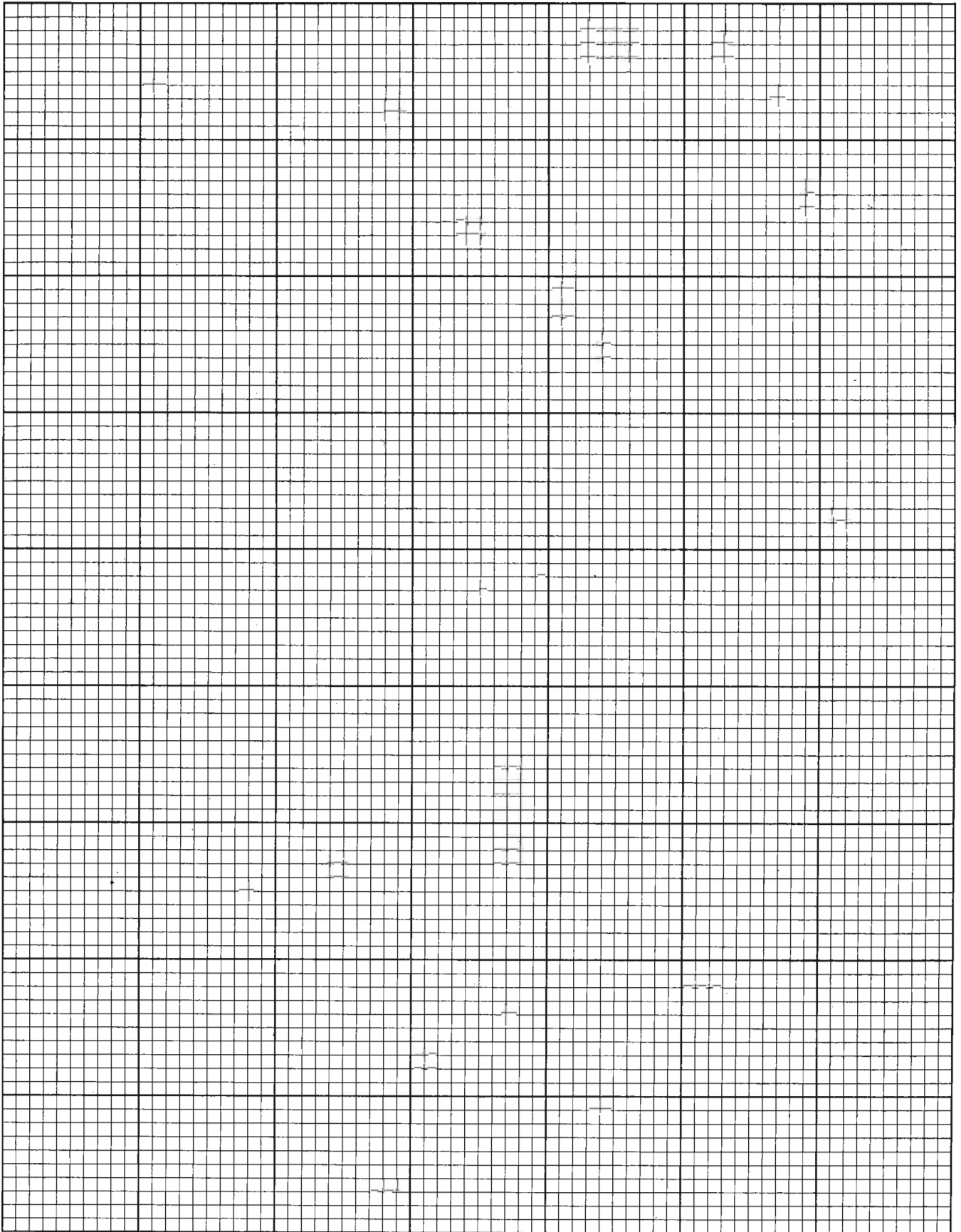

1 ft (0.3m)

Site Grid (metric system)

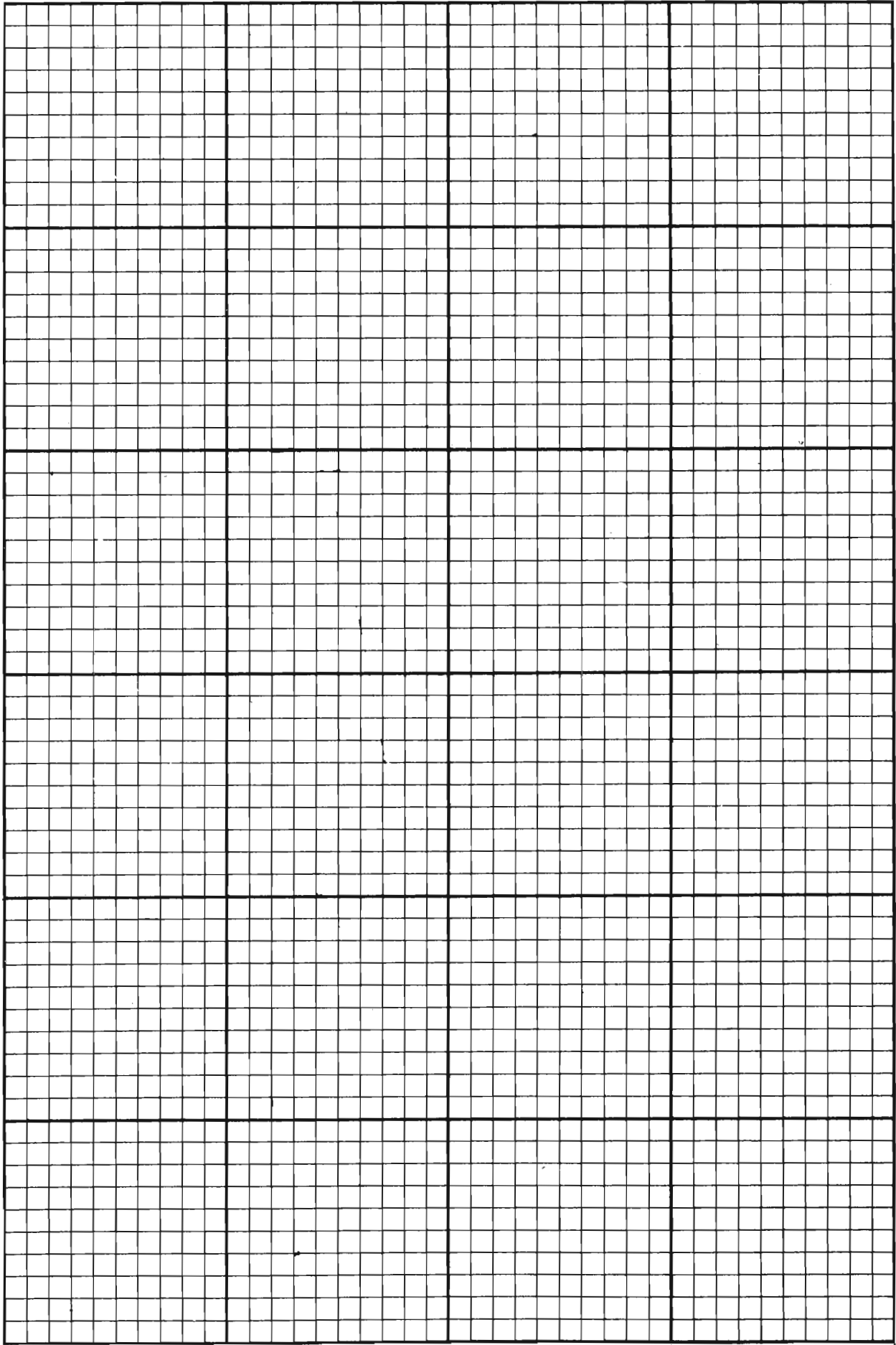

Typical Site Layout with WCS/30, Model 2221W Printer, Model 2230 Disk and Model 2209 Nine-Track Tape Drive.

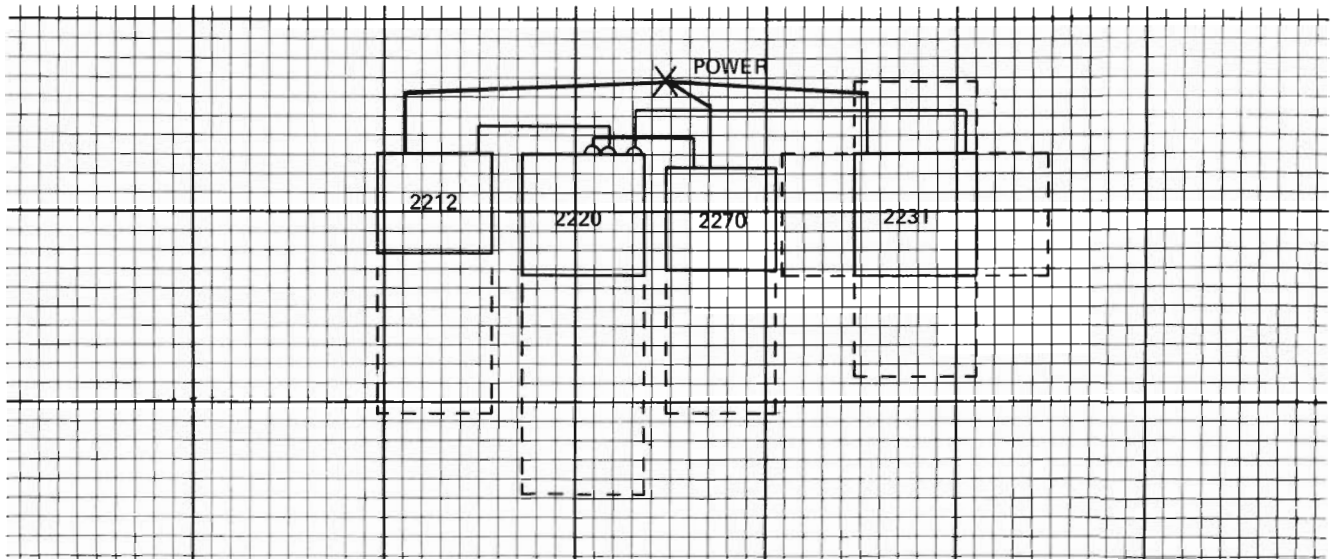
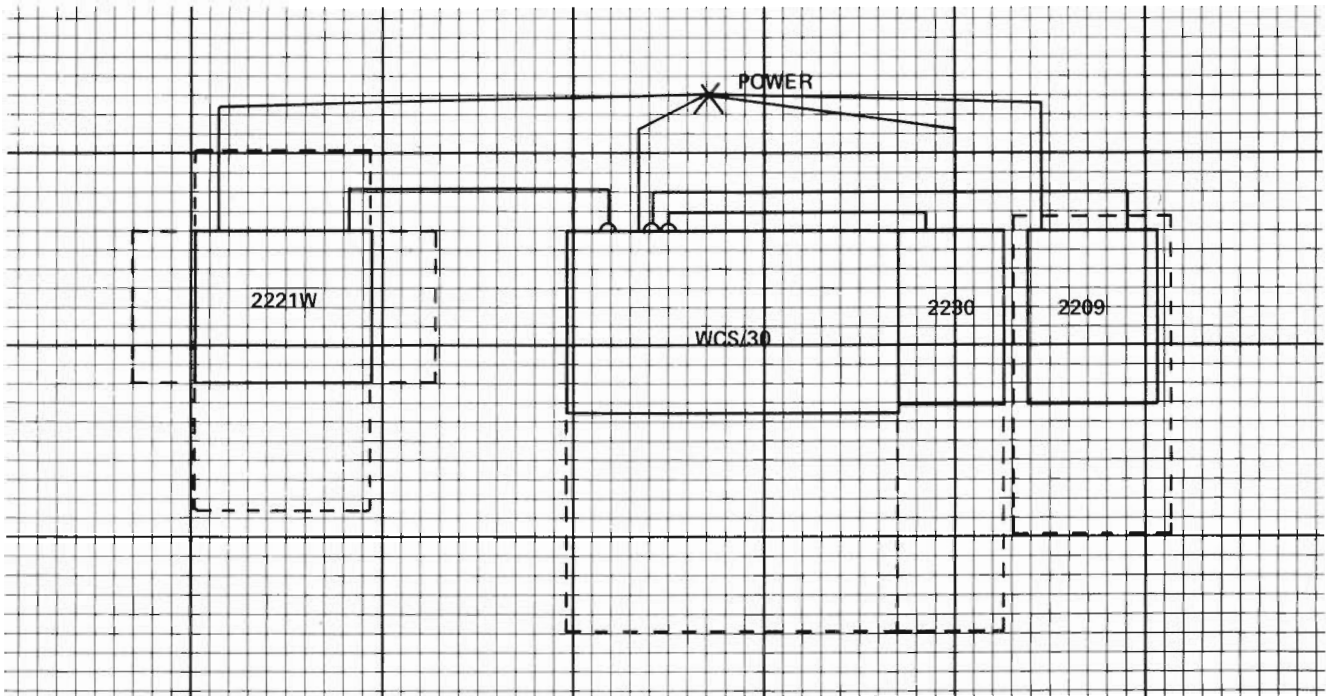

Line Drawings

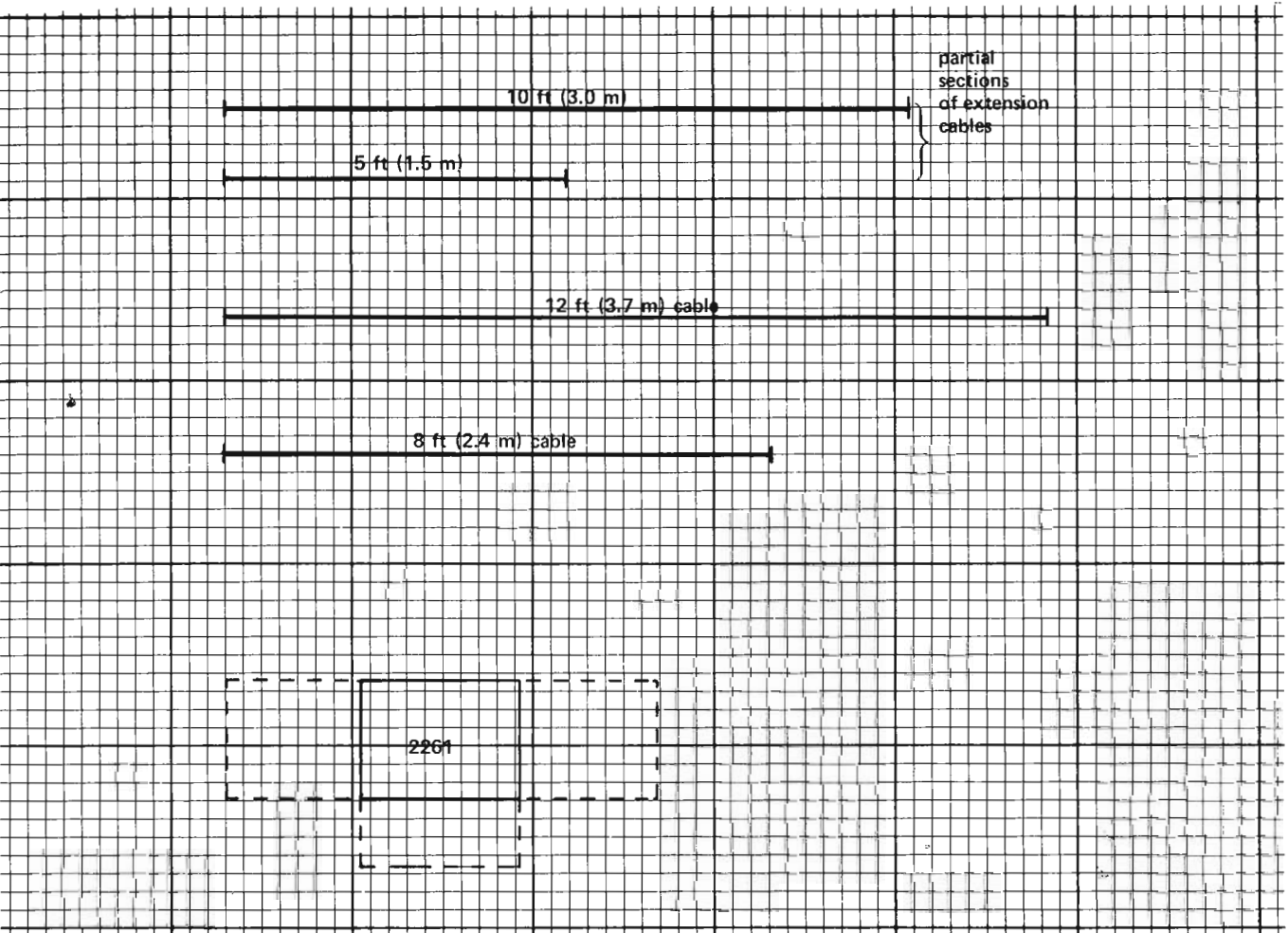
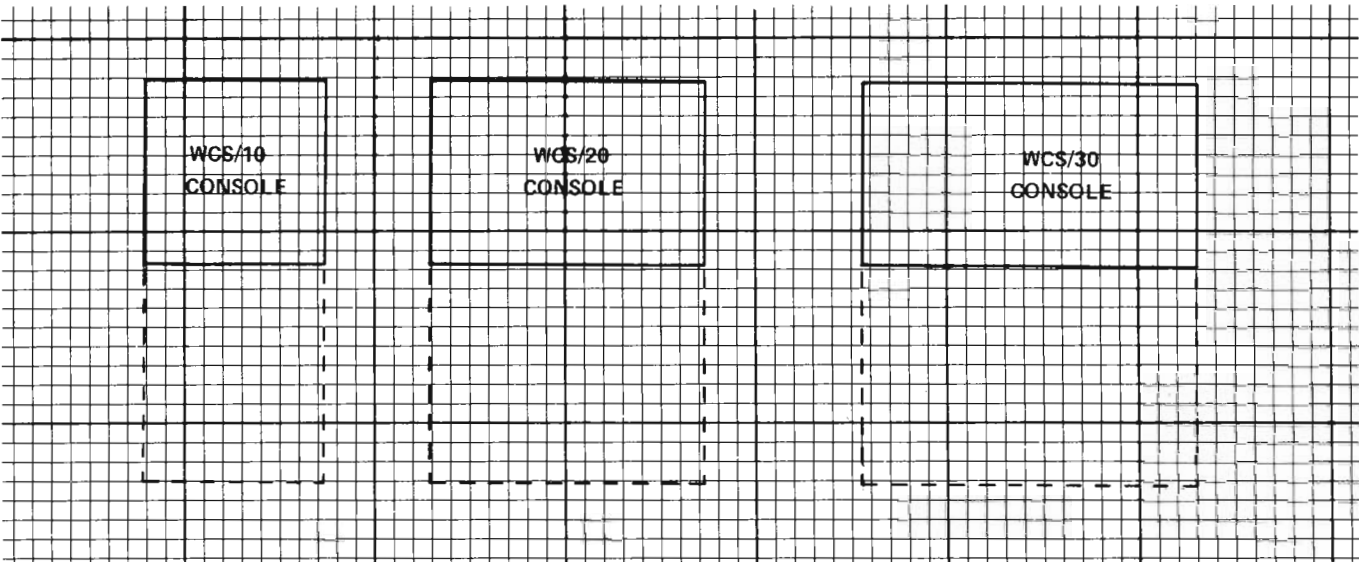

Line Drawings

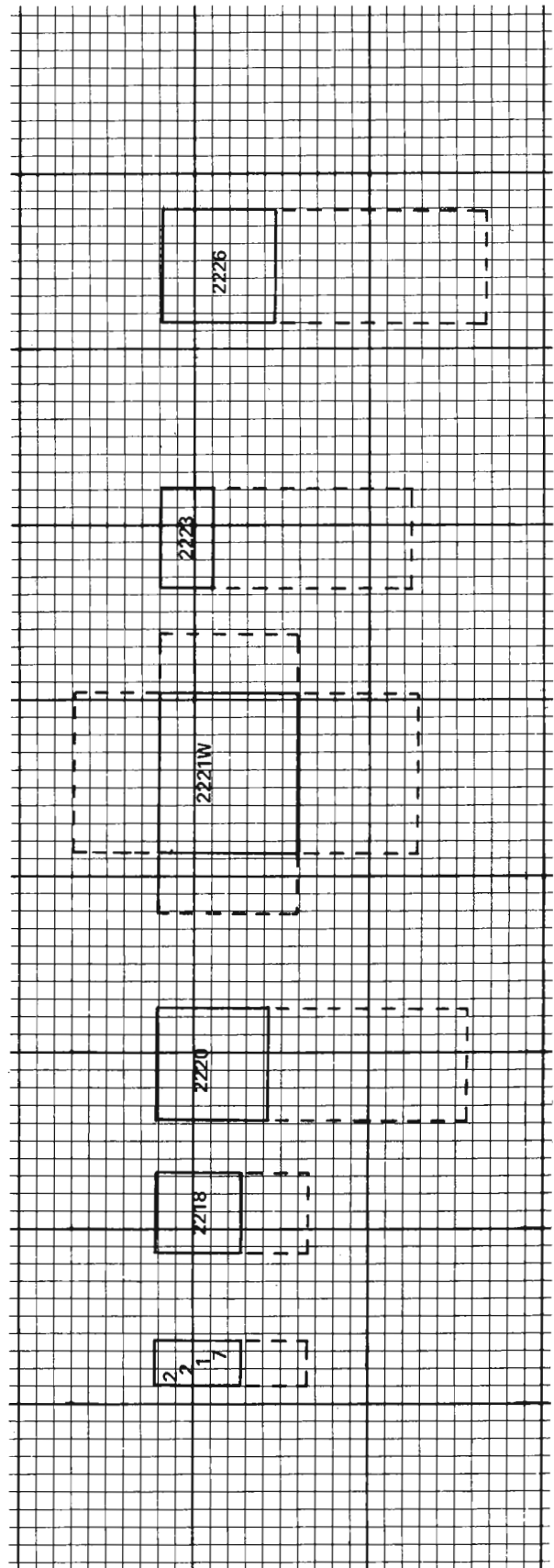
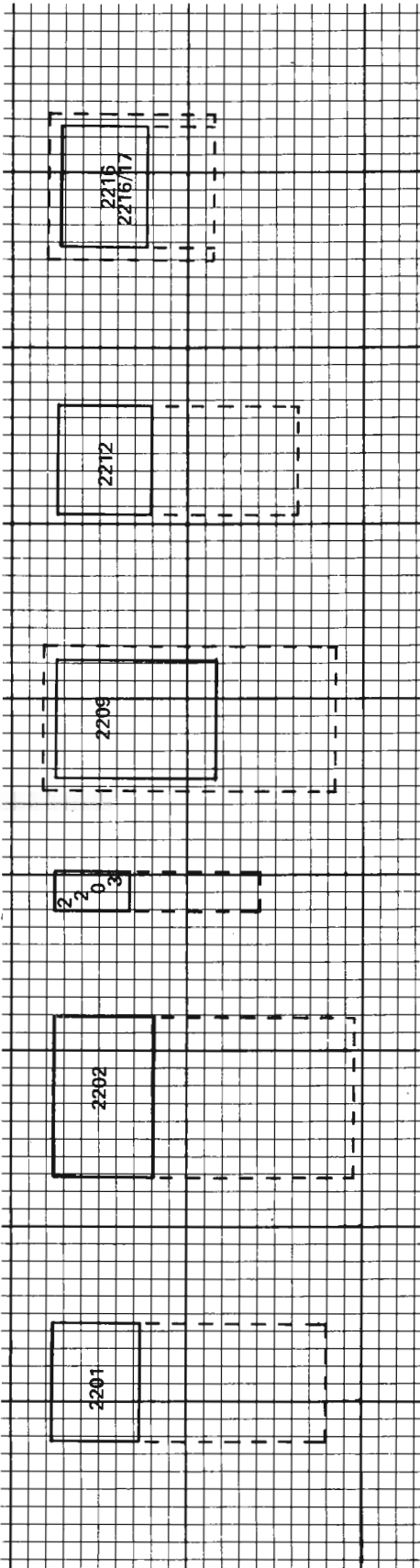

Line Drawings

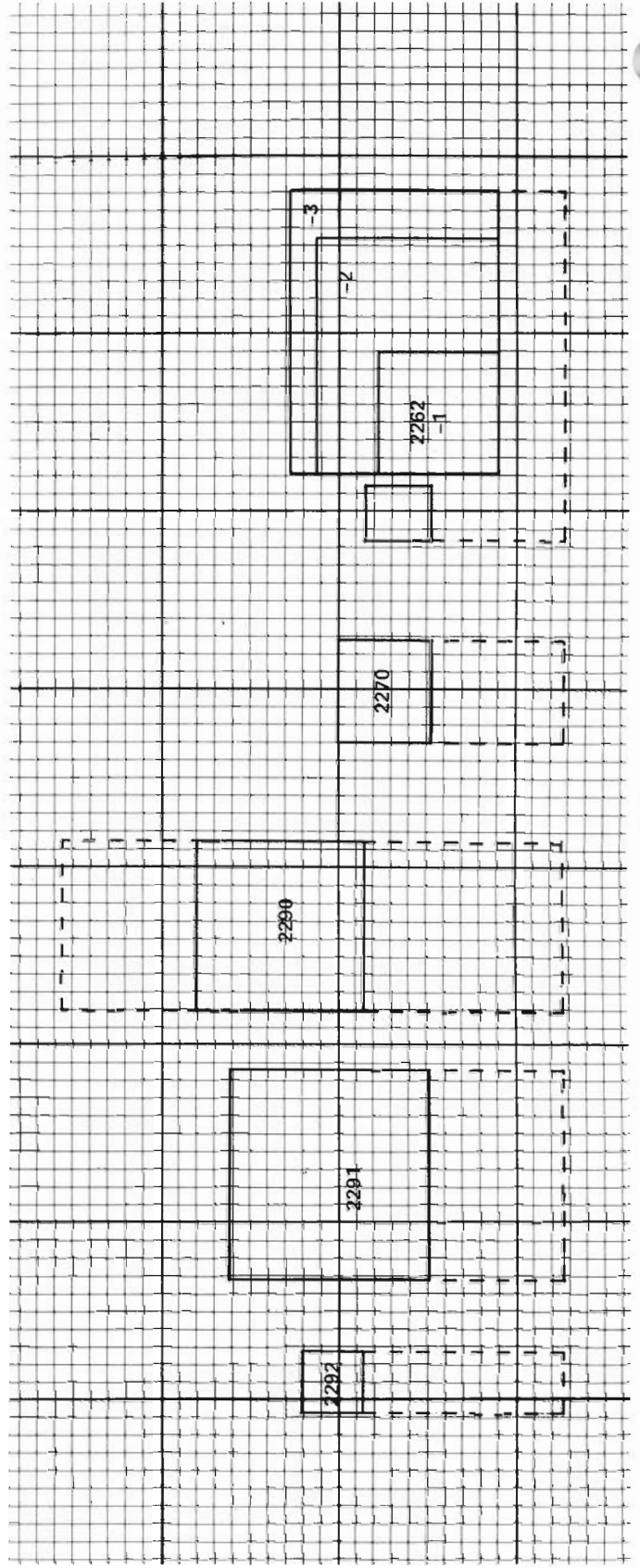
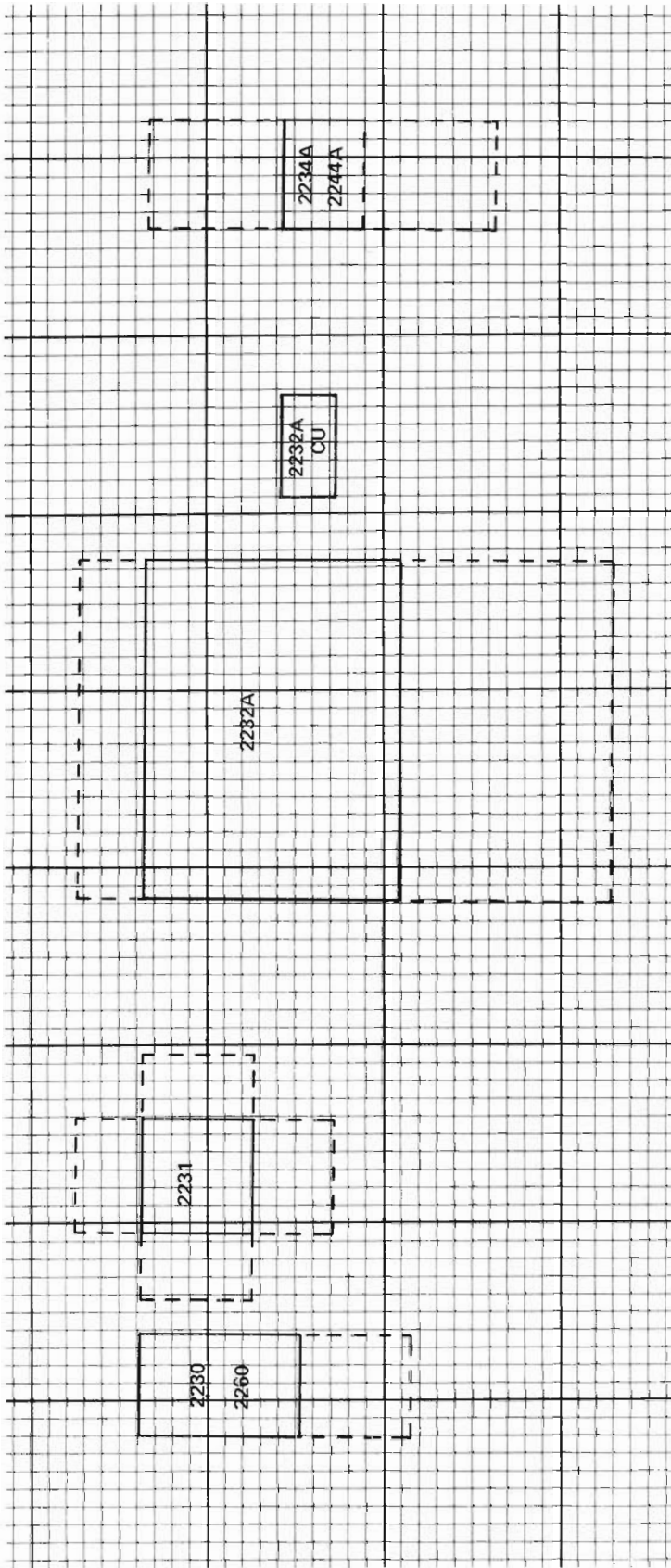

Available Units

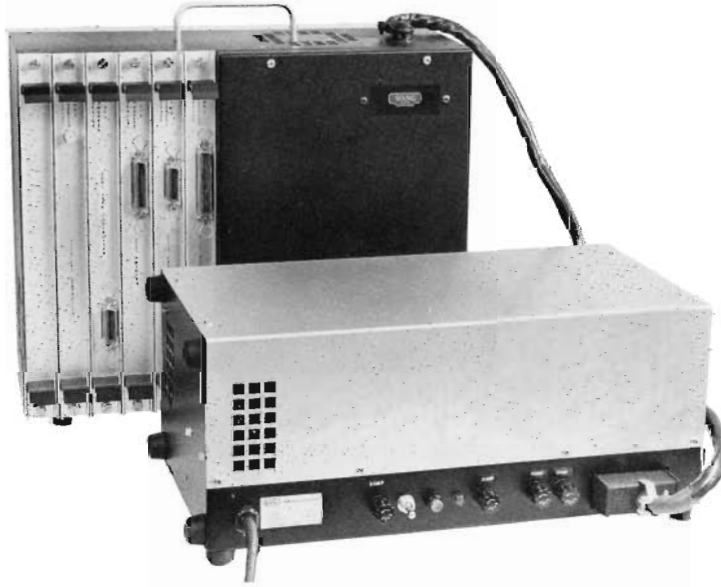

Central Processors

- | | |
|-------|--------------------|
| 2200S | 200 Watts |
| | 2.0 amps (115 VAC) |
| | 1.0 amp (230 VAC) |
| 2200T | 200 Watts |
| | 2.0 amps (115 VAC) |
| | 1.0 amp (230 VAC) |

WCS/10



Specifications

Dimensions

Height 40 in. (101.6 cm)
Depth 30 in. (76.2 cm)
Width 30 in. (76.2 cm)

Approximate Weight

117 lb (52.7 kg)

Clearance

36 in. (91.4 cm) in front of keyboard for operator chair

Electrical Requirements

275 watts
2.4 amps (115 VAC)
1.2 amps (230 VAC)

Cable

8 ft (2.4m) to power source

WCS/20



Specifications

Dimensions

Height 40 in. (101.6 cm)
Depth 30 in. (76.2 cm)
Width 46 in. (176.8 cm)

Approximate Net Weight

189 lb (85.6 kg)

Clearance

36 in. (91.4 cm) in front of keyboard for operator chair

Electrical Requirements

425 watts
3.7 amps (115 VAC)
1.9 amps (230 VAC)

Cables

8 ft (2.4m) to power source

WCS/30



Specifications

Dimensions

Height 40 in. (101.6 cm)
(Height to table top 32.5 in. (82.6 cm))
Depth 30 in. (76.2 cm)
Width 55 in. (139.7 cm)

Net Weight 189 lb (85.6 Kg)

Clearance

36 in. (91.4 cm) in front of keyboard
for operator chair

Electrical Requirements

900 watts
7.8 amps (115 VAC)
3.9 amps (230 VAC)

Cables

8 ft (2.4m) to power source

NOTE:

See also the specifications for the Model 2221W Line Printer and the Model 2230 Fixed/Removable Disk which are components of your WCS/30.

Model 2201
Output Writer



Specifications

Dimensions

Height: 8.75 in. (22.2 cm)
Depth: 15.6 in. (39.6 cm)
Width: 22 in. (55.9 cm)

Approximate Net Weight

51 lb (23.2 kg)

Clearance

36 in. (91.4 cm) in front of keyboard for operator chair

Electrical Requirements

125 watts
1.1 amps (115 VAC)
0.5 amp (230 VAC)

Cables

8 ft (2.4m) to CPU controller
8 ft (2.4m) to power source

Extension Cables

25 ft (7.6m)
50 ft (15.2m)
Maximum distance from CPU: 50 ft (15.2m)

Model 2202
Plotting Output Writer

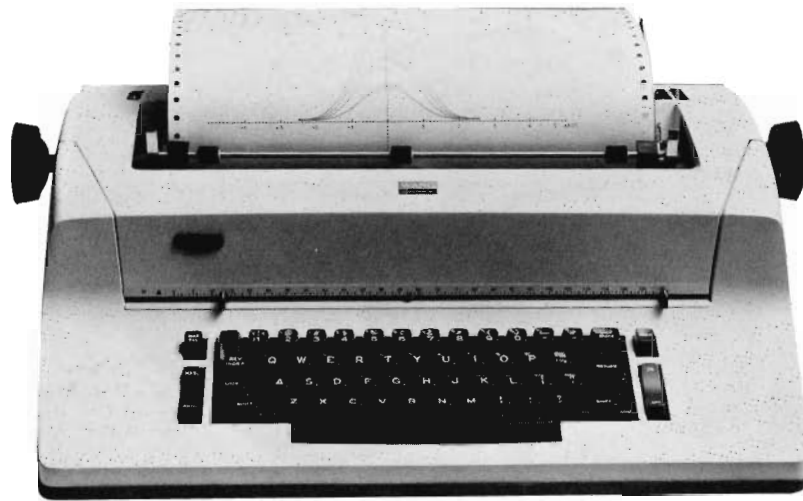

Specifications

Dimensions

Height: 33 in. (83.8 cm)
Depth: 18 in. (45.7 cm)
Width: 28.5 in. (72.4 cm)

Approximate Net Weight

96 lb (43.6 kg)

Clearance

36 in. (91.4 cm) in front of keyboard for operator chair

Electrical Requirements

125 watts
1.1 amps (115 VAC)
0.5 amp (230 VAC)

Cables

8 ft (2.4m) to CPU controller
8 ft (2.4m) to power source

Extension Cables

25 ft (7.6m)
50 ft (15.2m)
Maximum distance from CPU: 50 ft (15.2m)

Model 2203
Punched Tape Reader

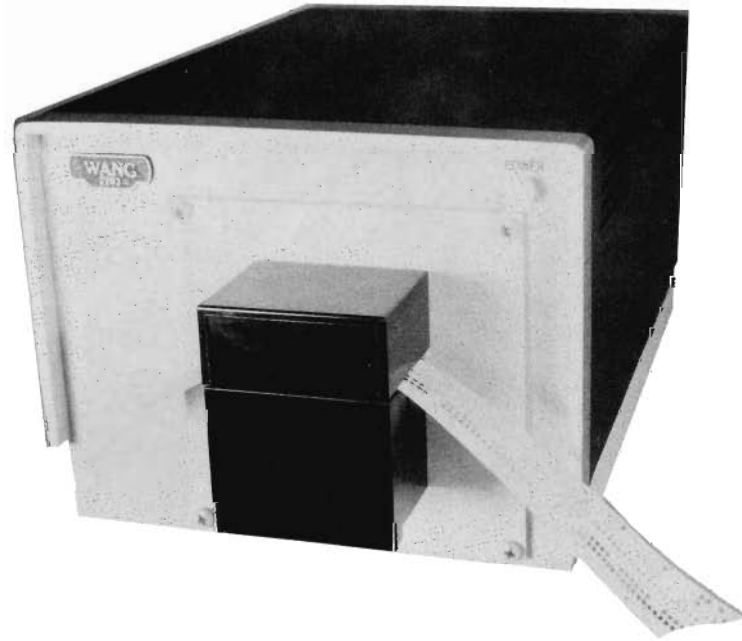

Specifications

Dimensions

Height: 6.5 in. (16.5 cm)
Depth: 13.5 in. (34.3 cm) with reader head
Width: 7.5 in. (19.1 cm)

Approximate Net Weight

13 lb (5.9 kg)

Clearance

24 in. (61m) in front of reader to access punched tape

Electrical Requirements

45 watts
0.4 amp (115 VAC)
0.2 amp (230 VAC)

Cables

8 ft (2.4m) to controller
8 ft (2.4m) to power source

Model 2209
Nine-Track Tape Drive

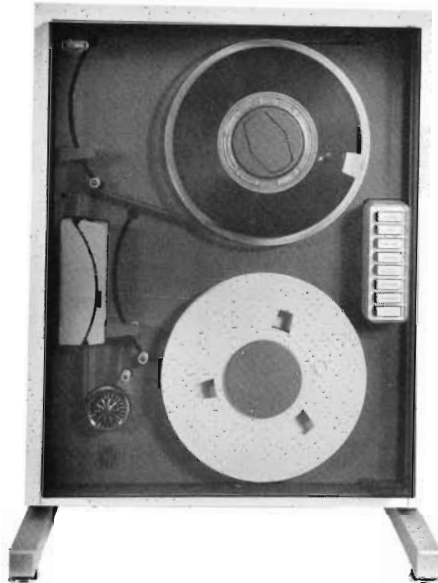

Specifications

Dimensions

Height: 28 in. (71 cm)
Depth: 28.5 in. (72 cm)
Width: 21 in. (54 cm)

Approximate Net Weight

158 lb (71.6 kg)

Clearance

Height: 2 in. (5 cm) above unit
Depth: not less than 50 in. (127 cm) to accommodate opening door
(22 in. (56 cm) in front of unit).
Width: 2 in. (5 cm) to left and right of unit

Electrical Requirements

325 watts @ 115 VAC, 2.8 amps
300 watts @ 230 VAC, 1.3 amps

Cables

12 ft (3.7m) to controller
8 ft (2.4m) to power source

Operating Environment

Temperature: 60° to 90°F (16° to 32°C)
Relative Humidity: 40% to 60%, non-condensing
Altitude: not above 20000 ft (6000m)

Model 2212
Analog Flatbed Plotter

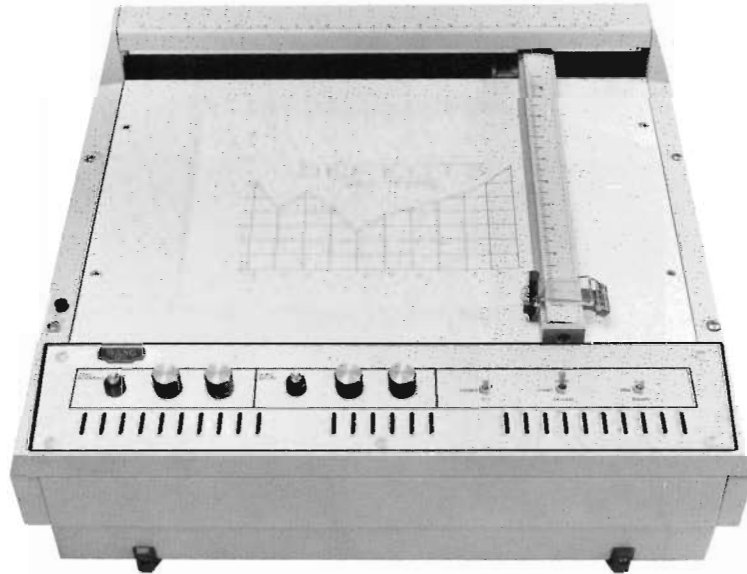

Specifications

Dimensions

Height: 6.5 in. (16.5 cm)
Depth: 17.25 in. (43.8 cm)
Width: 19 in. (48.3 cm)

Approximate Net Weight

35 lb (15.9 kg)

Clearance:

2 ft (.6m) above and in front of plotter to access plotting surface

Electrical Requirements

700 watts
0.6 amp (115 VAC)
0.3 amp (230 VAC)

Cables

8 ft (2.4m) to controller
8 ft (2.4m) to power source

Extension Cables

25 ft (7.6m)
50 ft (15.2m)
Maximum distance from CPU: 50 ft (15.2m).

Model 2216
CRT Executive Display
or
Model 2216/17
Combined CRT Executive Display/Single Tape Cassette Drive



Specifications

Dimensions

Height: 14 in. (35.6 cm)
Depth: 16 in. (40.6 cm)
Width: 21.5 in. (54.6 cm)

Approximate Net Weight

36 lb (14.4 kg)

Clearance

Approx. 11 in. (27.9 cm) in front of display unit for placement of keyboard. Rear of unit must be accessible to reach ON/OFF switch.

Electrical Requirements

Model 2216

65 watts
0.6 amp (115 VAC)
0.3 amp (230 VAC)

Model 2216/17

125 watts
1.1 amps (115 VAC)
0.5 amp (230 VAC)

Cables

8 ft (2.4m) to controller
8 ft (2.4m) to power source

Extension Cables

50 ft (15.2m)
100 ft (30.5m)
200 ft (61m)
Maximum distance from CPU: 500 ft (152.4m)

Model 2217
Single Tape Cassette Drive



Specifications

Dimensions

Height: 7 in. (17.8 cm)
Depth: 16 in. (40.6 cm)
Width: 7.5 in. (19.1 cm)

Approximate Net Weight

21 lb (9.5 kg)

Clearance

1 ft (30.5 cm) in front of unit to access door.

Electrical Requirements

100 watts
0.9 amp (115 VAC)
0.5 amp (230 VAC)

Cables

8 ft (2.4m) to controller
8 ft (2.4m) to power source

Extension Cables

25 ft (7.6m)
50 ft (15.2m)
Maximum distance from CPU: 50 ft (15.2m)

Model 2218
Dual Tape Cassette Drive



Specifications

Dimensions

Height: 7 in. (17.8 cm)
Depth: 16 in. (40.6 cm)
Width: 14 in. (35.6 cm)

Approximate Net Weight

38 lb (83.6 kg)

Clearance

1 ft (30.5 cm) in front of unit to access doors.

Electrical Requirements

150 watts
1.3 amps (115 VAC)
0.7 amp (230 VAC)

Cables

8 ft (2.4m) to controller
8 ft (2.4m) to power source

Extension Cables

25 ft (7.6m)
50 ft (15.2m)
Maximum distance from CPU: 50 ft (15.2m)

Model 2220
Integrated Console



Specifications

Dimensions

Height: 13.5 in. (34.3 cm)
Depth: 20.5 in. (52 cm)
Width: 19.8 in. (50.2 cm)

Approx. Net Weight

48 lb (21.7 kg)

Clearance

3 ft (91.4 cm) in front of keyboard for operator chair.

Electrical Requirements

125 watts
1.1 amps (115 VAC)
0.5 amp (230 VAC)

Cables

Three 8 ft (2.4m) cables to controllers
One 8 ft (2.4m) to power source

Extension Cables

25 ft (7.6m)
50 ft (15.2m)
Maximum distance from CPU: 50 ft (15.2m)

Model 2221W Line Printer

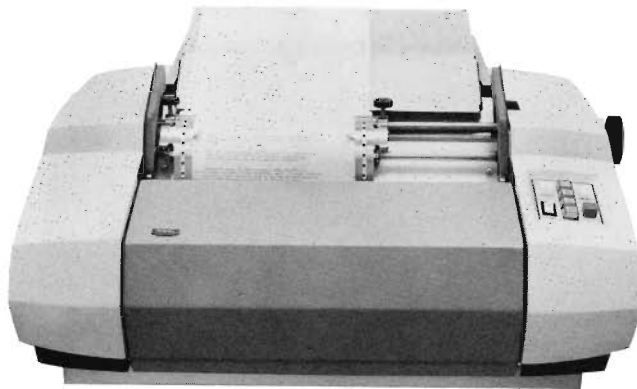

Specifications

Dimensions

Height	12 in. (31 cm)
Depth	25 in. (64 cm)
Width	29 in. (74 cm)

Net Weight

85 lb (38.6 kg)

Clearance

20 in. (50 cm) in front of unit to access paper and control panel; width of site not less than 50 in. (1.3m) to accommodate opening side covers of printer; depth of site must extend 16 in. (41 cm) behind printer to accommodate paper rack (rack extends 6 in. (16 cm) below bottom of printer).

Noise Output When Operating

65 decibels

Electrical Requirements

255 Watts
2.3 amps (115 VAC)
1.1 amps (230 VAC)

Cables

6 ft (1.8m) to power source
12 ft (3.7m) to controller

Operating Environment

40 to 80% relative humidity,
non-condensing

Extension Cables

25 ft (7.6m)
50 ft (15.2m)
Maximum distance from CPU: 50 ft (15.2m)

Model 2223
Alphanumeric/BASIC Keyword Keyboard



Specifications

Dimensions

Height: 3 in. (7.6 cm)
Depth: 10 in. (25.4 cm)
Width: 17.5 in. (44.5 cm)

Approximate Net Weight

7 lb (3.2 kg)

Clearance

3 ft (91 cm) in front of keyboard to accommodate operator chair.

Cables

8 ft (2.4m) to controller

Extension Cables

25 ft (7.6m)
50 ft (15.2m)
Maximum distance from CPU: 50 ft (15.2m)

Model 2226
CRT/Keyboard Console



Specifications

Dimensions

Height: 13.5 in. (34.3 cm)
Depth: 20.5 in. (52 cm)
Width: 19.8 in. (50.2 cm)

Approximate Net Weight

38.5 lb (17.4 kg)

Clearance

3 ft (91 cm) in front of keyboard to accommodate operator chair.

Electrical Requirements

65 watts
0.6 amp (115 VAC)
0.3 amp (230 VAC)

Cables

Two 8 ft (2.4m) cables to controllers
One 8 ft (2.4m) cable to power source

Extension Cables

25 ft (7.6m)
50 ft (15.2m)
Maximum distance from CPU: 50 ft (15.2m)

Model 2230
Fixed/Removable Disk Drive
(to 5 megabytes)

or

Model 2260
Fixed/Removable Disk Drive
(to 10 megabytes)



Specifications

Dimensions

Height 32.5 in. (82.6 cm)
Depth 29 in. (73 cm)
Width 17.5 in. (44.5 cm)

Net Weight

126 lb (57 kg)

Electrical Requirements

800 Watts
7.0 amps (115 VAC)
3.5 amps (230 VAC)

Clearance

20 in. (50 cm) in front of unit
20 in. (50 cm) above unit
for insertion and removal of
disks and access to switches

Cables

10 ft (3.7m) to controller
12 ft (30.5 cm) to power source

Model 2231W
Line Printer (112 column)



Specifications

Dimensions

Height: 10 in. (25 cm)
Depth: 18 in. (46 cm)
Width: 24 in. (61 cm)

Approximate Net Weight

60 lb (27 kg)

Clearance

8 in. (20.3 cm) to the left and right of printer to access ON/OFF switch
in back of printer.
8 in. (20.3 cm) in back of printer to accommodate open cover.

Electrical Requirements

230 watts
2 amps (115 VAC)
1 amp (230 VAC)

Cables

12 ft (3.7m) to CPU plug jack
8 ft (2.4m) to power source

Model 2232A
Digital Flatbed Plotter



Specifications

Dimensions

<u>Plotter</u>	<u>Control Unit</u>
Height: 9.5 in. (24.1 cm)	19 in. (48.3 cm)
Depth: 46 in. (116.8 cm)	10 in. (25.4 cm)
Width: 60.25 in. (153.0 cm)	18 in. (45.7 cm)

Approximate Net Weight

<u>Plotter</u>	<u>Control Unit</u>
112 lbs (50.1 kg)	30 lb (13.6 kg)

Clearance

12 in. (30 cm) in back of table to accommodate x-axis motor and cable
3 ft (91 cm) above table to access plotting surface and pen assembly
Control unit must be nearby with power switch accessible.

Electrical Requirements

175 watts
1.5 amps (115 VAC)
0.8 amp (230 VAC)

Cables

12 ft (3.7m) cable, x-axis motor to control unit
8 ft (2.4m) cable, control unit to controller
8 ft (2.4m) cord, control unit to power source

Model 2234A/44A
Hopper Feed Card Readers



Specifications

Dimensions

Height: 11 in. (27.9 cm)
Depth: 14 in. (35.5 cm)
Width: 19.25 in. (48.9 cm)

Approximate Net Weight

60 lbs (27.3 kg)

Clearance

2 ft (61 cm) above, behind and in front of unit to access card hoppers and switches.

Electrical Requirements

1650 watts (start-up), 750 (running)
14.3 amps (115 VAC)
7.2 amps (230 VAC)

Cables

8 ft (2.4m) to controller
8 ft (2.4m) to power source

Model 2261
High Speed Printer

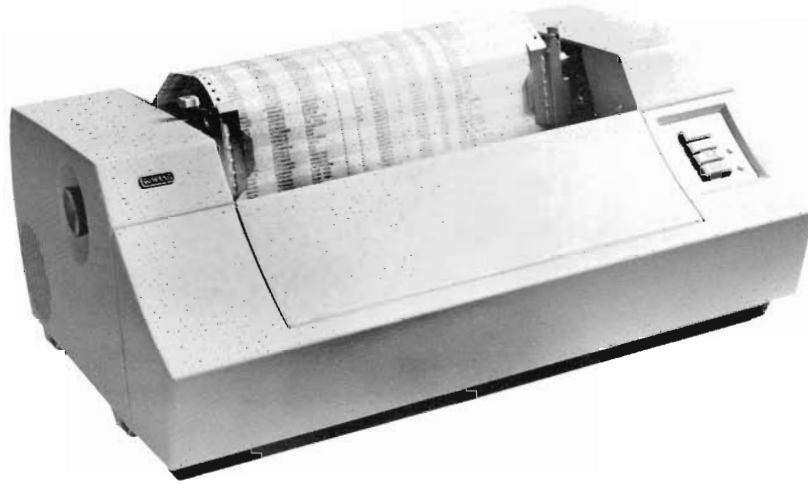

Specifications

Dimensions

Height: 11.5 in. (29.2 cm)
Depth: 20 in. (50.8 cm)
Width: 27.75 in. (70.5 cm)

Approximate Net Weight

118 lb (53.5 kg)

Clearance

At least 24 in. (61 cm) on either side of printer to accommodate opening side covers.

Electrical Requirements

375 watts
3.3 amps (115 VAC)
1.6 amps (230 VAC)

Cables

8 ft (2.4 in.) to controller
8 ft (2.4 in.) to power source

Extension Cables

25 ft (7.6m)
50 ft (15.2m)
Maximum distance from CPU: 50 ft (15.2m)

Model 2262
Digitizer

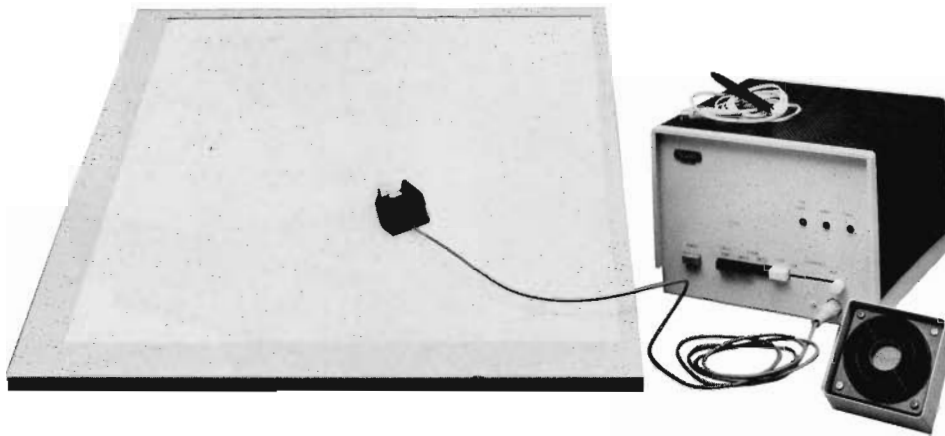

Specifications

Dimensions

of Digitizer Chassis

Height: 7.25 in. (18.1 cm)
Depth: 11.75 in. (29.4 cm)
Width: 9.75 in. (24.4 cm)

of Tablets

2262-1 22 by 22 in. (56 by 56 cm)
2262-2 32 by 42 in. (81 by 107 cm)
2262-338 by 50 in. (97 by 127 cm)

Approximate Net Weight

14 lb (6.3 kg)

2262-1 20 lb (9 kg)
2262-2 60 lb (27 kg)
2262-3 81 lb (37 kg)

Clearance

To access switches on chassis and tablet surface.

Electrical Requirements

50 watts
0.4 amp (115 VAC)
0.2 amp (230 VAC)

Cables

8 ft (2.4m) from chassis to controller
8 ft (2.4m) from chassis to power source
6 ft (1.8m) from tablet to chassis
4 ft (1.2m) from chassis to stylus or cursor

Model 2270
Diskette Drives



Specifications

Dimensions

Height: 19 in. (47.5 cm)
Depth: 16.3 in. (40.8 cm)
Width: 17.5 in. (43.8 cm)

Approximate Net Weight

68 lb (30.6 kg)

Clearance

2 ft (61 cm) in front of unit to access doors.

Electrical Requirements

225 watts
2.0 amps (115 VAC)
1.0 amp (230 VAC)

Cables

12 ft (3.7m) to controller
8 ft (2.4m) to power source

A multiplexer can be used to increase distance from the CPU to a maximum of 500 ft (152.4m).

Model 2290
CPU/Peripheral Stand



Specifications

Dimensions

Height: 28.25 in. (71.8 cm)
Depth: 30 in. (76.2 cm)
Width: 30 in. (76.2 cm)

Approximate Net Weight

69 lb (31 kg)

Clearance

3 ft (91 cm) in front of unit for operator chair
2 ft (61 cm) in back of unit for cables and air circulation

Electrical Requirements

Contains four electrical outlets, rated collectively at 1400 watts
12.2 amps (115 VAC)
6.1 amps (230 VAC)

Cables

8 ft (2.4m) cable to power source

Model 2291
Plotter Stand



Specifications

Dimensions

Height: 26.3 in. (66.8 cm)
Depth: 36 in. (91.4 cm)
Width: 37.5 in. (95.3 cm)

Approximate Net Weight

65 lbs (29.5 kg)

Clearance

2 ft (61 cm) above unit to accommodate plotter.

Model 2292
Auxiliary Display

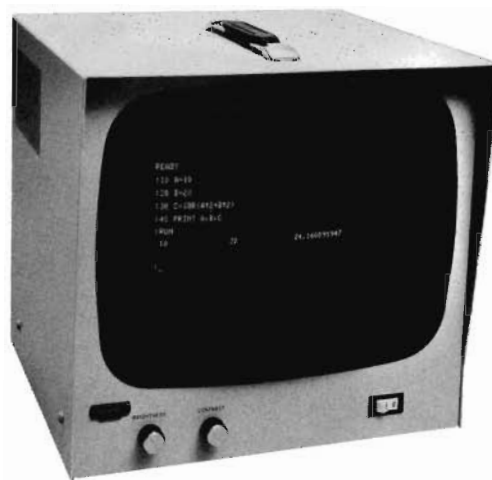

Specifications

Dimensions

Height: 8 in. (20.3 cm)
Depth: 10.5 in. (26.7 cm)
Width: 10.5 in. (26.7 cm)

Approximate Net Weight

36 lb (16.3 kg)

Clearance

3 ft (91 cm) in front of unit to view screen and access switch and controls.

Electrical Requirements

60 watts
0.5 amp (115 VAC)
0.3 amp (230 VAC)

Cables

8 ft (2.4m) to power source
25 ft (7.6m) to controller
Extension Cables
50 ft (15.2m)
100 ft (30.4m)
200 ft (60.9m)
Maximum distance from CPU: 500 ft (152.4m)

To help us to provide you with the best manuals possible, please make your comments and suggestions concerning this publication on the form below. Then detach, fold, tape closed and mail to us. All comments and suggestions become the property of Wang Laboratories, Inc. For a reply, be sure to include your name and address. Your cooperation is appreciated.

700-3807

TITLE OF MANUAL: **2200 INSTALLATION GUIDE**

COMMENTS:

—
Fold

—
Fold



Fold

FIRST CLASS
PERMIT NO. 16
Tewksbury, Mass.

BUSINESS REPLY MAIL
NO POSTAGE STAMP NECESSARY IF MAILED IN THE UNITED STATES

— POSTAGE WILL BE PAID BY —

WANG LABORATORIES, INC.
836 NORTH STREET
TEWKSBURY, MASSACHUSETTS 01876

Cut along dotted line.

Attention: Marketing Department

Fold

Printed in U.S.A.

Notes

Notes

Notes

IN CENTER DIVISION
1000 W. WASHINGTON ST.
MILWAUKEE, WIS. 53233

**WANG LABORATORIES
(CANADA) LTD.**
49 Valleybrook Drive
Don Mills, Ontario M3B 2S6
TELEPHONE (416) 449-2175
Telex: 069-66546

WANG EUROPE, S.A.
Buurtweg 13
9412 Ottergem
Belgium
TELEPHONE 053/704514
Telex: 26077

**WANG DO BRASIL
COMPUTADORES LTDA.**
Rua Barao de Lucena No. 32
Botafogo ZC-01 20,000
Rio de Janeiro RJ
Brasil
TELEPHONE 226-4326
Telex: 2123296

**WANG COMPUTERS
(SO. AFRICA) PTY. LTD.**
Corner of Allen Rd. & Garden St.
Bordeaux, Transvaal
Republic of South Africa
TELEPHONE (011) 48-6123

**WANG INTERNATIONAL
TRADE, INC.**
836 North Street
Tewksbury, Massachusetts 01876
TELEPHONE (617) 851-4111
TWX 710-343-6769
Telex: 94-7421

WANG SKANDINAVISKA AB
Pyramidvaegen 9A
S-171 36 Solna,
Sweden
TELEPHONE 08-826814
Telex: 11498

WANG NEDERLAND B.V.
Damstraat 2
Utrecht, Netherlands
(030) 93-09-47
Telex: 47579

WANG PACIFIC LTD.
902-3 Wong House
26-30, Des Voeux Road, West
Hong Kong
TELEPHONE 5-435229
Telex: 74879

WANG INDUSTRIAL CO., LTD.
110-118 Kuang-Fu N. Road
Taipei, China
TELEPHONE 784181-3
Telex: 21713

WANG GESELLSCHAFT M.B.H.
Formanekgasse 12-14
A-1190 Vienna, Austria
TELEPHONE 36.32.80
Telex: 74640

WANG S.A./A.G.
Markusstrasse 20
CH-8042 Zurich 6
Switzerland
TELEPHONE 41.1.26.6866
Telex: 59151

WANG COMPUTER PTY. LTD.
55 Herbert Street
St. Leonards, 2065
Australia
TELEPHONE 439-3511
Telex: 25469

WANG ELECTRONICS LTD.
1 Olympic Way, 4th Floor
Wembley Park,
Middlesex, England
TELEPHONE 01/903/6755
Telex: 923498

WANG FRANCE S.A.R.L.
Tour Gallieni, 1
78/80 Ave. Gallieni
93170 Bagnolet, France
TELEPHONE 33.1.3602211
Telex: 68958F

WANG LABORATORIES GMBH
Moselstrasse 4
6000 Frankfurt AM Main
West Germany
TELEPHONE (0611) 252061
Telex: 04-16246

WANG DE PANAMA (CPEC) S.A.
Apartado 6425
Calle 45E, No. 9N. Bella Vista
Panama 5, Panama

WANG COMPUTER SERVICES
836 North Street
Tewksbury, Massachusetts 01876
TELEPHONE (617) 851-4111
TWX 710-343-6769
Telex: 94-7421

DATA CENTER DIVISION
20 South Avenue
Burlington, Massachusetts 01803
TELEPHONE (617) 272-8550

WANG

LABORATORIES, INC.

836 NORTH STREET, TEWKSBURY, MASSACHUSETTS 01876. TEL. (617) 851-4111, TWX 710 343-6769. TELEX 94-7421

Printed in U.S.A.
700-3807
4-76-5M
Price: see current list